



Reid Middleton

Civil & Structural Engineering
Surveying, & Planning

Civil Projects

Shaping Earth, Guiding Water



Stormwater Management

Storm drainage systems collect and convey stormwater to protect people and property. Just as importantly, these systems must keep our waters clean and protect the natural environment. Our civil engineers are experts at designing storm drainage systems that perform their important primary function. Moreover, our systems respect the ecological environment and blend with the site, becoming an amenity and even a focal point. Stormwater detention ponds become reflecting pools and habitat for small wildlife species. Water quality treatment systems remove sediments, oils, and other pollutants. Low Impact Design (LID) elements such as permeable pavement and rain gardens recharge groundwater aquifers.

Reid Middleton engineers understand the complex codes and permitting process. We work with numerous federal, state, and local jurisdictions.

Utilities

Providing communications, light, and heat, these are the invisible systems that sustain our way of life in business, education, home life, and defense. They maintain our health and provide protection from fire. Our engineers plan and design water systems, sanitary sewer systems, and natural gas systems for individual site developments, campuses, and extensions to municipal utility systems. Developments range from green field sites to brown field sites with contaminated soils, and existing urban and campus settings where utilities must be maintained to support current uses during construction.

We design utility systems to provide decades of reliable, low maintenance service, and we build in flexibility to provide for expansion and change.

Sustainable Design

Reid Middleton offers LEED-accredited civil and structural engineers, experience designing green and sustainable solutions, and experience supporting architect-led teams intent upon providing a comprehensive building and site design that achieves LEED certification. Our notable green and sustainable design projects include Terrace Park & Maplewood K-8 Schools (Edmonds School District), the Science and Technology Centers at Green River Community College, and Union Slough on the Snohomish River, where we converted 19 acres of pasture land into habitat for salmon.

*Swanson Wetland Mitigation,
Snohomish County, WA*

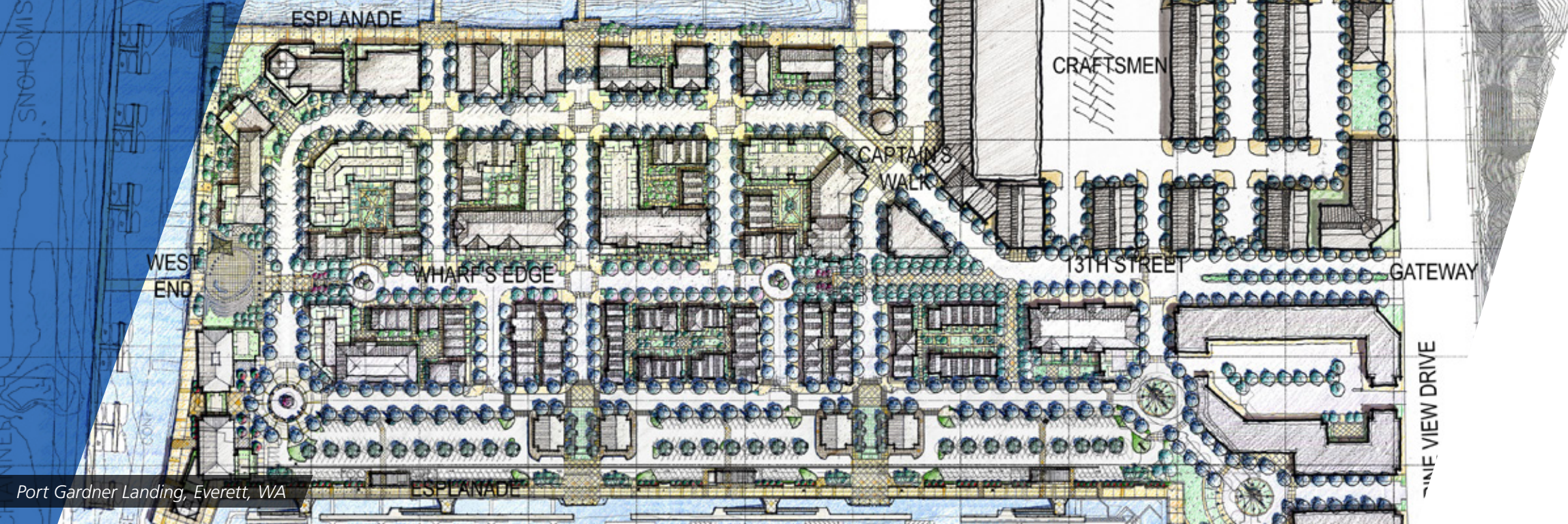

Port Gardner Infrastructure Redevelopment, Port of Everett, WA

Reid Middleton provided planning and civil engineering design of a 67-acre, mixed-use waterfront development on the Everett waterfront. The project is a complex multi-phase development requiring maintaining operations to existing businesses, interfacing with multiple design teams, coordinating with numerous Port of Everett departments, and complex permitting processes from local, state, and federal authorities.

Port Gardner Landing, Everett, WA



Arlington City Hall Police Annex, Arlington, WA

Letter to Reid Middleton Civil Engineers

"I would like to thank Hugh Kuyper and Julian Dodge, for their outstanding performance... These projects were challenging and provided the project team with schedule constraints, security concerns, permitting issues, construction phasing constraints and limited budgets.

[Their] considerate customer service and organized project approach, utilized the resources and time of the project team effectively throughout the project. I look forward to an opportunity to work with Reid Middleton on future projects."

*Julie Nakahara, Project Manager
Washington State*



Snohomish County Administration Building, Everett, WA



Green River College Trades Building, Auburn, WA

Performance Regarding Island-Wide Deep Culvert Assessments

"Very well presented."

"...it looks great."

"...impressive and eye opening."

"...please extend my thanks to the entire team for their hard work."

*Bruce Oyloe – Department of Public Works & Engineering
City of Bainbridge Island*

Performance Regarding P-239 EA-18G Facility Improvements

"Reid Middleton's representatives were very cooperative and concerned with customer satisfaction; often initiating processes to address and avoid potential problems/issues with the site and existing conditions."

*Ernest Doeleman
NAVFAC NW*



About Reid Middleton

We are civil & structural engineers, surveyors, & planners. People Engineering for People.
People count on us to look out for their safety and quality of life. We know what we do is important, and we take the responsibility seriously. The great thing about it is that we love doing it & delivering it in an uncommonly personal way.

| Site Development | Project Delivery | Stormwater Management | Utilities |
|-----------------------------------|-----------------------------|--------------------------------------|-------------------------------------------|
| Erosion Control Programs | Construction Administration | Detention & Retention Ponds & Vaults | Water Transmission & Distribution Systems |
| NPDES Compliance | Feasibility Studies | Wet Ponds | Sanitary Sewer Collection & Conveyance |
| Stormwater Collection & Treatment | Public Involvement | Biofiltration Swales | Pump Stations |
| Parking Lots & Roads | | Drainage & Basin Studies | Outfalls |
| Grading & Paving | | Oil/Water Separators | Wastewater Treatment & Disposal (on-site) |
| Truck Access & Maneuvering | | Water Quality Treatment Facilities | |



Contact

EVERETT, WASHINGTON

425.741.3800

SAN DIEGO, CALIFORNIA

858.668.0707

ANCHORAGE, ALASKA

907.562.3439